

RADO 7 (RA-40701)



Product description

With recessing box



Luminaire structure

- Die-cast aluminium housing
- Pre-treated before powder coating ensuring high corrosion resistance
- Two cable entries for through wiring
- Stainless steel fasteners in grade 304 with zinc flake coating (ZFC)
- Durable silicone rubber gasket
- Clear toughened glass
- Integral control gear

Light symbol



G

Product colour



01- Black (RAL 9011)    02- Dark Grey (RAL 7043)    03- White (RAL 9003)    05- Matt Silver (RAL 9006)



06- Bronze (RAL 6014)

Special finishes upon request



SU01- Concrete Urban    SU02- Softscape Urban    SU03- Stone Urban    SU04- Corten Urban



SW01- OAK Woodland

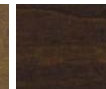

SW02- Walnut Woodland



SW03- PINE Woodland

Technical information

Light source	1 COB
Light source type	COB
Dimming type	DALI, On/Off
Material	Aluminium
Weight	6.5 kg
Operating temperature	-20°C to 40°C

Luminaire	
Power	20 W
Lumen	1382 - 1399 lm
Efficacy	69 - 70 lm/W
CCT / CRI	3000K CRI80, 4000K CRI80
Drive current	500 mA
Driver option	Integral control gear
Driver	Constant current (CC)
Input voltage	220-240 V 50/60 Hz

Optic	G [42°x69°]
Bug	B0-U1-G2
ULR	1.36%
ULOR	1.36%
CIE flux code n°3	81
MacAdam Ellipse	3 SDCM
Lifetime L90B10 (hrs)	61,000

RADO 7 (RA-40701)

Product variants

HOW TO SPECIFY

LIGA	-	RA-40701	-	500	-	G	-	8030	-	ND	-	01
MODEL	OUTPUT	DISTRIBUTION	CRI/CCT	DIMMING	COLOUR FINISH							
RA-40701	500 20W	G	8030	ND	01 BLACK							
			8040	DALI	02 DARK GREY							
					03 WHITE							
					05 MATT SILVER							
					06 BRONZE							
					S - SPECIAL FINISH							

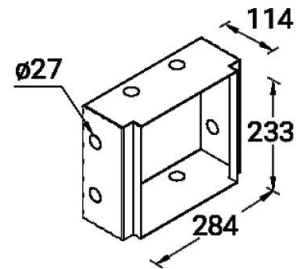
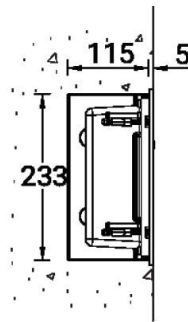
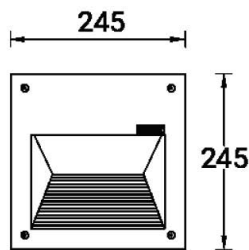

RECESSING BOX