

RADO 7 (RA-40702)



Product description

With recessing box



Luminaire structure

- Die-cast aluminium housing
- Pre-treated before powder coating ensuring high corrosion resistance
- Two cable entries for through wiring
- Stainless steel fasteners in grade 304 with zinc flake coating (ZFC)
- Durable silicone rubber gasket
- Clear toughened glass
- Integral control gear

Light symbol



G

Product colour



01- Black (RAL 9011) 02- Dark Grey (RAL 7043) 03- White (RAL 9003) 05- Matt Silver (RAL 9006)



06- Bronze (RAL 6014)

Special finishes upon request



SU01- Concrete Urban SU02- Softscape Urban SU03- Stone Urban SU04- Corten Urban



SW01- OAK Woodland



SW02- Walnut Woodland

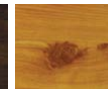

SW03- PINE Woodland

Technical information

Light source	1 COB
Light source type	COB
Dimming type	On/Off
Material	Aluminium
Weight	6.5 kg
Operating temperature	-20°C to 40°C

Luminaire	
Power	38 W
Lumen	2082 - 2192 lm
Efficacy	55 - 58 lm/W
CCT / CRI	3000K CRI80, 4000K CRI80
Drive current	950 mA
Driver option	Integral control gear
Driver	Constant current (CC)
Input voltage	220-240 V 50/60 Hz

Optic	G [48°x75°]
Bug	B0-U3-G3
ULR	7.2%
ULOR	7.2%
CIE flux code n°3	79

RADO 7 (RA-40702)

Product variants

HOW TO SPECIFY

LIGA	-	RA-40702	-	950	-	G	-	8030	-	ND	-	01
		MODEL		OUTPUT		DISTRIBUTION		CRI/CCT		DIMMING		COLOUR FINISH
		RA-40702		950 38W		G		8030		ND		01 BLACK
								8040				02 DARK GREY
												03 WHITE
												05 MATT SILVER
												06 BRONZE
												S - SPECIAL FINISH

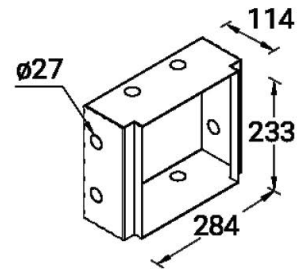
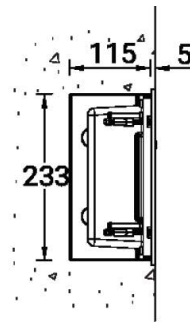
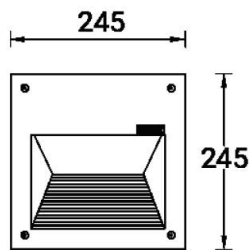

RECESSING BOX